

重载系列滚子链

Heavy duty series roller chains

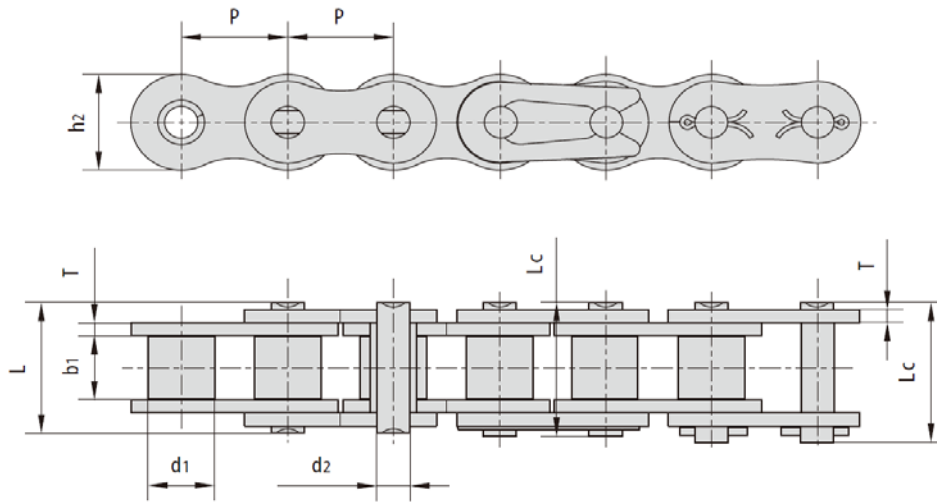

单排滚子链/套筒链 Simplex roller chains & bush chains

ANSI 链号	节距	滚子直径	内节内宽	销轴直径	链板厚度	内链板高度	销轴长度		抗拉强度	每米长重
ANSI Chain	Pitch	Roller diameter	Width between inner	Pin diameter	Plate thickness	Inner plate depth	Pin length		Ultimate tensile strength	Weight per meter
	P mm	d1 mm	b1 mm	d2 mm	T mm	h2 mm	L mm	Lc mm	U.T. S. (kN)	Wt. (kg/m)
*35H-1	9.525	5.08	4.77	3.58	1.50	9.00	13.30	14.30	10.80	0.41
40H-1	12.70	7.95	7.85	3.96	2.03	12.00	18.80	19.90	19.10	0.82
50H-1	15.875	10.16	9.40	5.08	2.42	15.09	22.10	23.40	30.20	1.25
60H-1	19.05	11.91	12.57	5.94	3.25	18.00	29.20	31.00	42.70	1.87
80H-1	25.40	15.88	15.75	7.92	4.00	24.00	36.20	37.70	71.40	3.10
100H-1	31.75	19.05	18.90	9.53	4.80	30.00	43.60	46.90	112.40	4.52
120H-1	38.10	22.23	25.22	11.10	5.60	35.70	53.50	57.50	160.90	6.60
140H-1	44.45	25.40	25.22	12.70	6.40	41.00	57.60	62.20	217.30	8.30
160H-1	50.80	28.58	31.55	14.27	7.20	47.80	68.20	73.00	285.80	10.30
180H-1	57.15	35.71	35.48	17.46	8.00	53.60	75.90	81.60	341.80	14.83
200H-1	63.50	39.68	37.85	19.85	9.50	60.00	86.60	93.50	444.50	19.16
240H-1	76.20	47.63	47.35	23.81	12.70	72.30	109.60	115.90	622.50	30.40

*套筒链：表中滚子直径d1为套筒直径

*Bush chain: d1 in the table indicates the external diameter of the bush