

重载传动用弯板链

Heavy duty cranked-link transmission chains

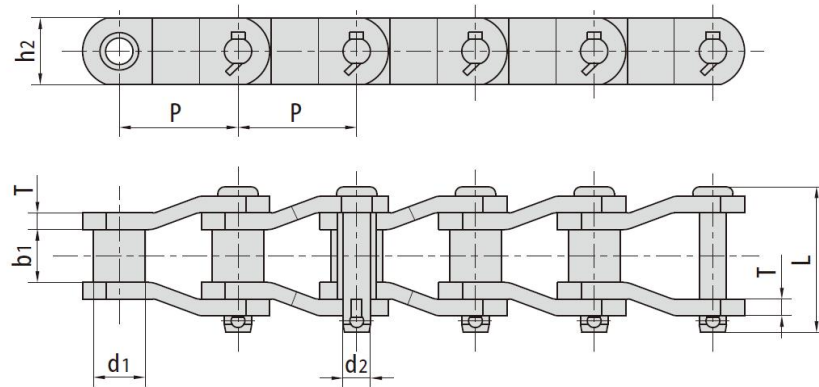

华宇链号	节距	滚子直径	内节内宽	销轴直径	链板厚度	内链板高度	销轴长度	抗拉强度	每米长重
HUAYU Chain No.	Pitch	Roller diameter	Width between inner plates	Pin diameter	Plate thickness	Inner plate depth	Pin length	Ultimate tensile strength	Weight per meter
	P mm	d1 mm	b1 mm	d2 mm	T mm	h2 mm	L mm	U.T. S. (kN)	Wt. (kg/m)
MXS432	42.01	22.23	25.40	11.10	4.80	28.50	57.90	80.80	5.65
1409F1	44.450	25.40	25.40	13.97	6.30	43.20	65.90	217.00	9.65
R3112	50.80	28.70	31.00	14.20	6.40	41.40	73.90	168.90	10.70
R3112F1	50.800	28.70	31.00	15.06	7.90	41.40	79.50	195.60	12.23
SS2065	50.80	28.58	32.50	15.05	7.90	38.00	79.50	220.00	12.14
2010.00	63.50	31.75	38.10	15.90	7.90	47.80	89.00	250.00	13.53
2010H	63.50	31.75	31.75	15.88	9.50	41.50	97.00	250.00	11.91
2010SH	63.50	31.75	38.10	15.88	9.50	41.50	97.00	300.00	12.00
*SS588F4	66.27	22.23	30.40	11.11	4.80	32.00	60.00	90.00	5.05
MXS882	66.27	22.23	28.58	11.10	6.40	28.50	68.50	115.60	5.30
SS588	66.27	22.23	28.60	11.11	6.40	28.60	63.70	130.00	5.46
SS588F1	66.27	22.23	27.00	11.11	6.40	28.60	62.00	88.90	5.39
SS588F2	66.27	22.23	27.00	9.53	5.60	25.40	59.00	84.46	4.26
*MXS882F2	66.27	22.23	28.58	11.10	6.40	28.50	66.60	115.60	5.39
MXS882F1	66.27	22.10	28.58	11.10	6.40	28.50	68.50	110.00	5.39
SS588F7	66.27	22.35	26.90	11.20	4.80	28.70	60.00	80.00	4.52
*MX603	76.20	22.50	38.00	14.00	8.00	40.00	88.00	147.00	9.20
*MXS3011F1	77.90	31.75	39.60	19.05	9.70	57.00	100.00	407.50	17.68
2512(MXS3011)	77.90	41.28	39.60	19.05	9.70	57.00	100.00	340.00	18.40
2512F2	77.90	41.28	38.50	19.05	10.00	60.00	103.40	400.00	20.28
2512F3	77.90	41.28	40.00	18.60	11.00	46.70	104.20	340.00	18.15
2512F4	77.90	41.28	39.60	19.05	12.00	60.00	110.00	407.50	23.60
SS568H	77.90	41.30	39.70	19.05	9.50	57.00	97.60	460.00	19.80
SS568HF2	77.90	31.75	39.70	19.05	9.50	57.00	98.50	447.00	16.90
SS568HF3	77.90	41.30	39.70	19.05	11.00	57.00	104.10	489.30	20.85
SS568HF4	77.90	41.30	39.70	19.05	10.00	57.00	100.00	490.00	19.80
2510.00	78.10	31.75	36.90	16.00	8.00	40.00	94.80	271.00	10.72
2510F1	78.10	31.75	36.60	16.00	8.00	38.10	88.90	124.50	9.93
2510F2	78.10	31.75	36.60	15.75	8.00	38.10	88.00	225.00	11.70
2510H	78.10	31.75	36.90	16.50	9.50	45.00	95.30	280.40	12.70

*套筒链：表中滚子直径d1为套筒直径

*Bush chain: d1 in the table indicates the external diameter of the bush